

THE PRESERVE AT CANYON RIDGE



LAUREN

PLAN DETAILS-3242 SQ FT

- Convenient One-Level Living
- 4-5 Bedrooms, 3-4 Full Baths
- Hardwoods Throughout Main Living Area
- Fireplace
- Gracious Columns Define Formal Dining Area
- Formal Dining Room Can Be Re-Purposed To Become A 4th Bedroom
- Kitchen Has Large Island Counter & Generous Walk-In Pantry
- Kitchen Is Graced By Windows On Either Side Of Cooking Appliances
- Master Bedroom Has Very Large Walk-In Closet
- Two Covered Porches (Front and Back)
- Optional 2nd Floor: May Have Bedroom, Full Bath, and/or Game Room
- 2- Car Garage
- Garage For 3rd Car Optional (depending on width of lot)

All drawings and measurements are for marketing purposes and are approximate.

ThePreserveAtCanyonRidge.com
770-776-8665

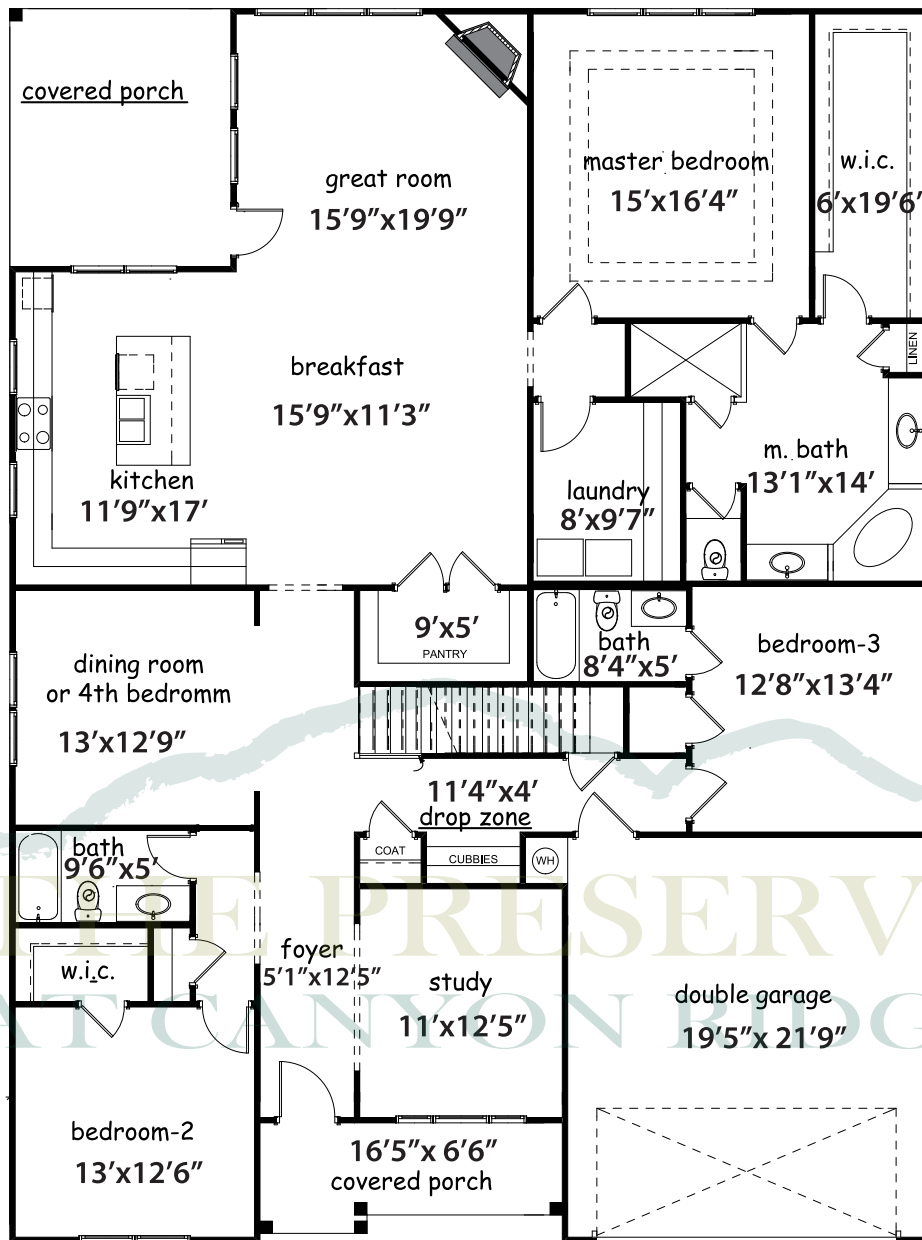

Main Floor-3242 SQ FT

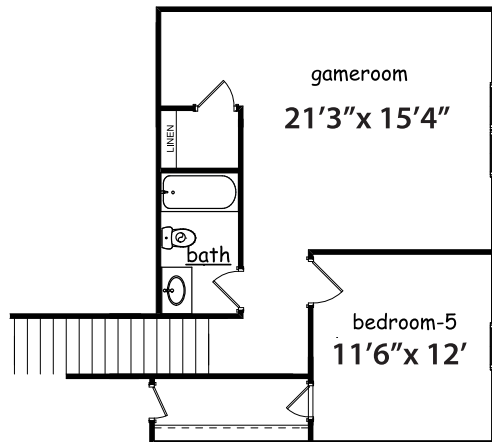

Optional Second Floor