

THE PRESERVE AT CANYON RIDGE



ELIZABETH

PLAN DETAILS-2644 SQ FT

- 4 Bedroom
- Master Suite on Main: Vaulted Bath, Large Walk-In Closet
- 2nd Bedroom or Office with Bath on Main Level
- 2 Secondary Bedrooms, 1 Bath Upstairs
- Spacious Vaulted Family Room
- Hardwoods Throughout Main Living Area
- Lots of Kitchen Cabinets and Counter, Including Large Island
- Gracious Dining Room with Elegant Columns
- Open Floor Plan
- Optional Covered Back Porch
- Optional Screened Porch
- Vaulted Loft Upstairs Overlooks Family Room

All drawings and measurements are for marketing purposes and are approximate.

ThePreserveAtCanyonRidge.com
770-776-8665

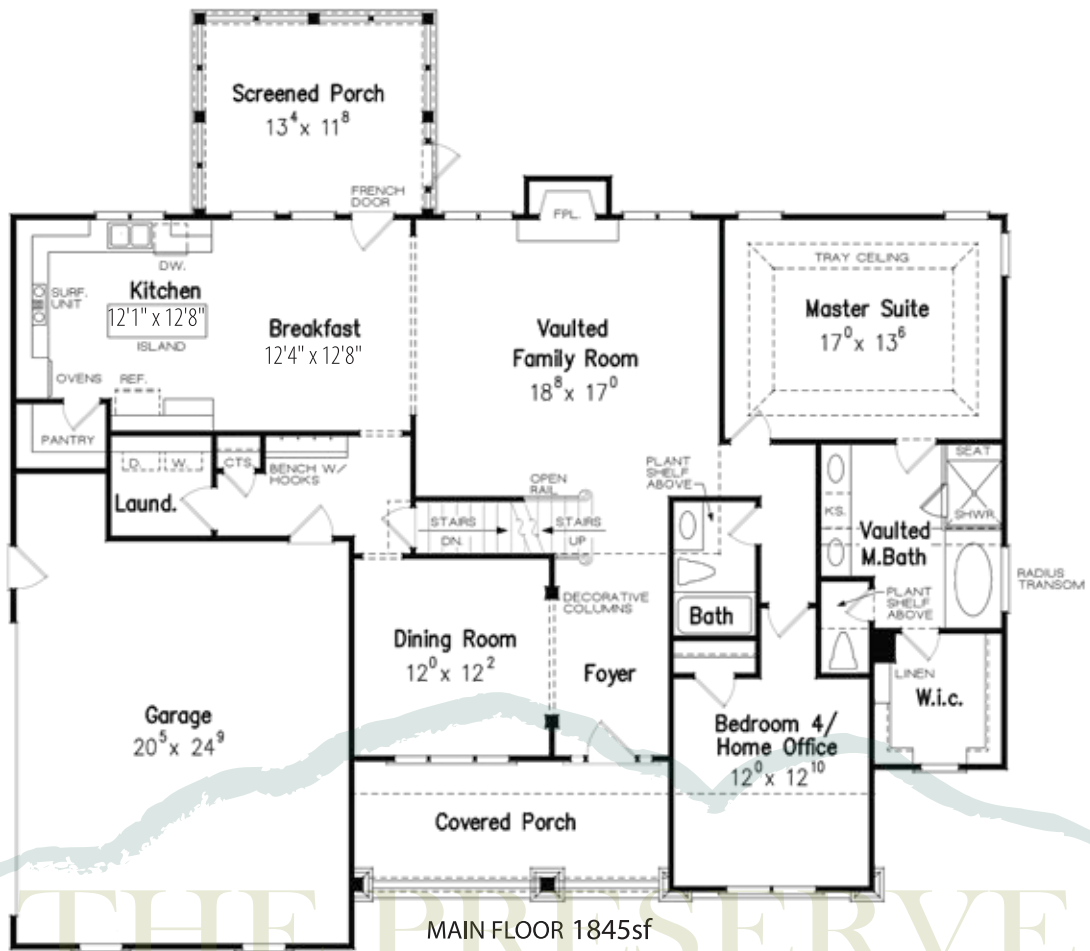

THE PRESERVE AT CANYON RIDGE

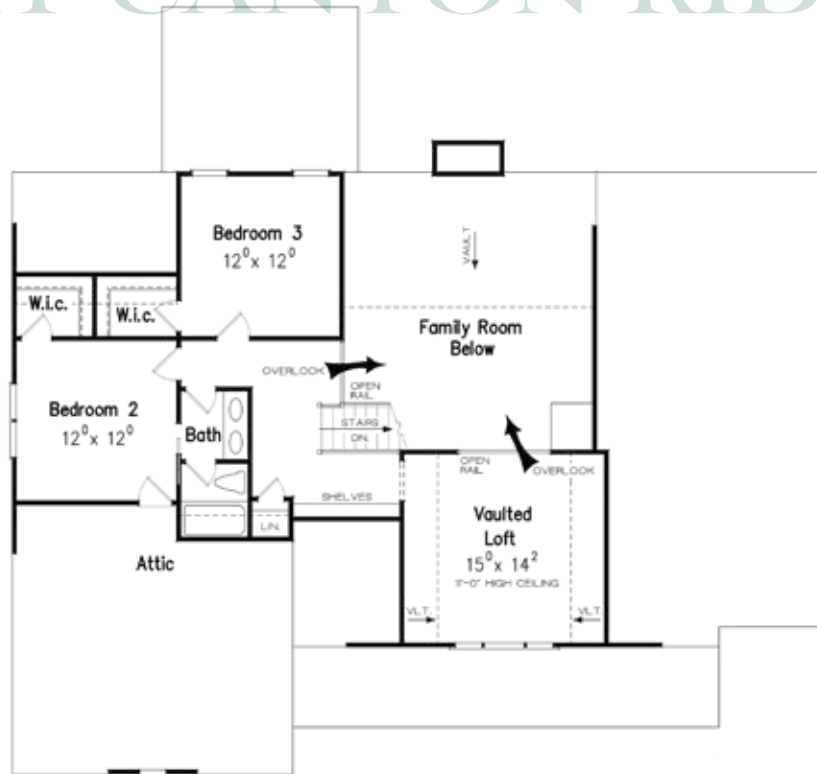

SECOND FLOOR 799sf