

THE PRESERVE AT CANYON RIDGE



All drawings and measurements are for marketing purposes and are approximate.

Due to COVID 19: Because of supply chain delays or lack of material availability, materials and selections might be substituted with equal quality and pricing by the builder.

MICHEL 2- RANCH- 2156 SQ FT

- Convenient One-Level Living
 - 3 Bedrooms, 2 Baths
 - Hardwoods Throughout Main Living Area
 - Master Bedroom Has Very Large Walk-In Closet
 - Abundant Windows In Dining/Morning Room
 - Kitchen Has Large Island Counter & Generous Walk-In Pantry
 - Open Floor Plan
 - Fireplace
 - Entry From Garage Includes "Mud Room"
 - Two Covered Porches (Front and Back)
 - 2-Car Garage (3-Car Garage Optional Depending on Lot Width)
- OPTIONAL/UPGRADES**
- Add Shake-Style Siding
 - Add Additional Stone to Front Elevation
 - Add Sunroom to back covered porch

ThePreserveAtCanyonRidge.com

770-776-8665

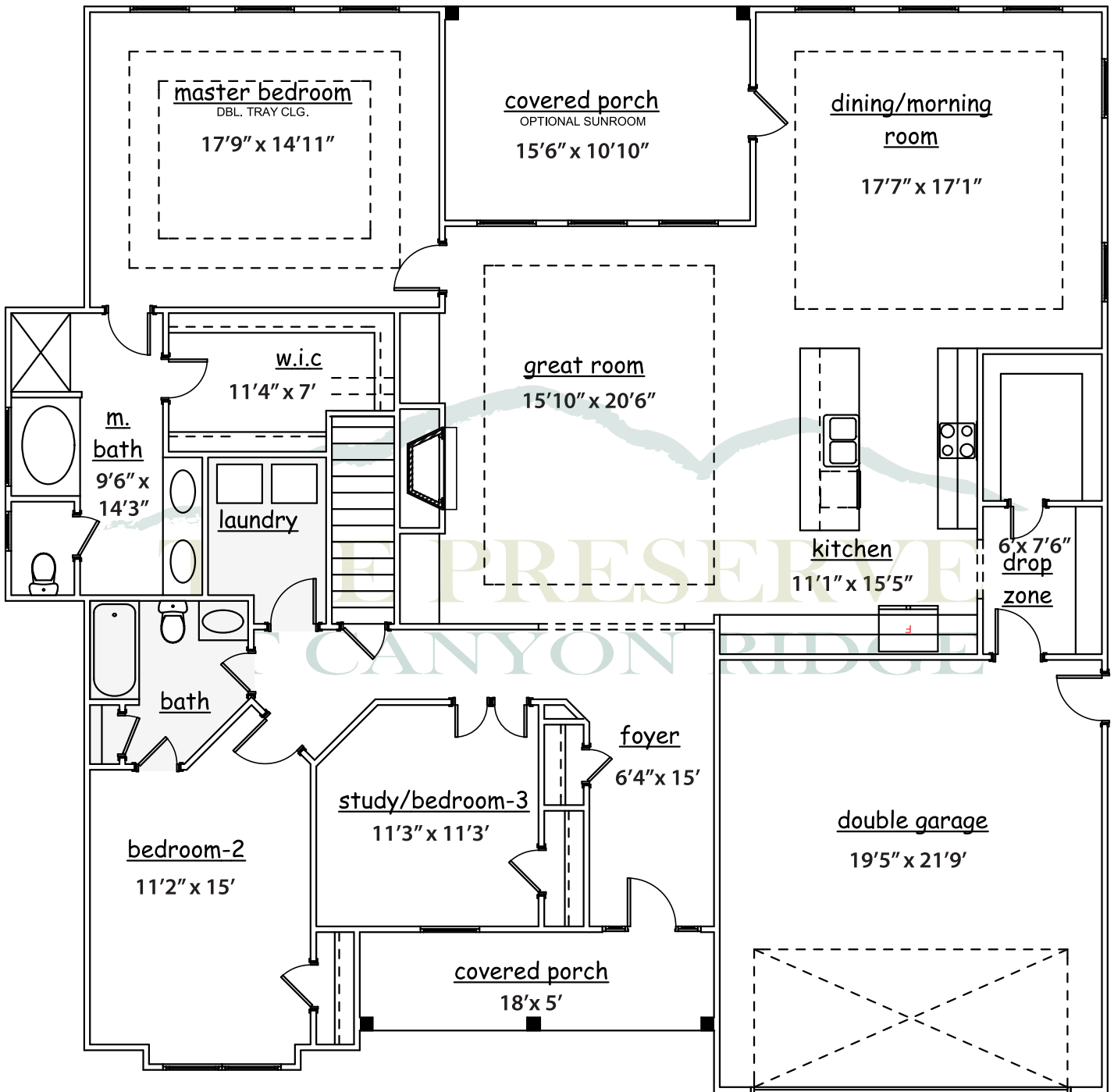

2156 SQ FT

All drawings and measurements are for marketing purposes and are approximate.

Due to COVID 19: Because of supply chain delays or lack of material availability, materials and selections might be substituted with equal quality and pricing by the builder.